

# Potentiometers

## 6.5x7mm Phenolic Trimming Potentiometers

## GP43 Series

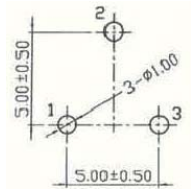
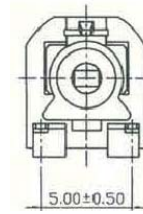
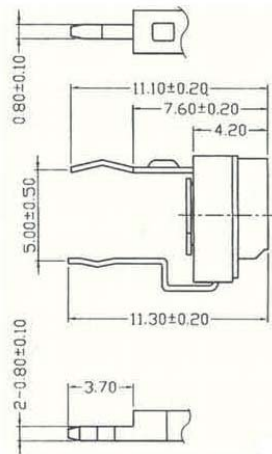
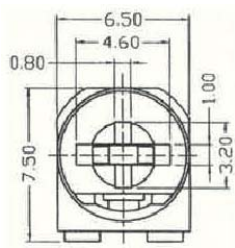

P.C.B. LAYOUT

### GP43T... Straight Type

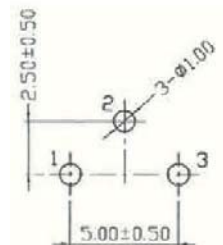
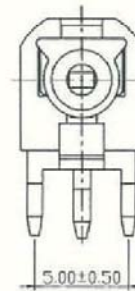
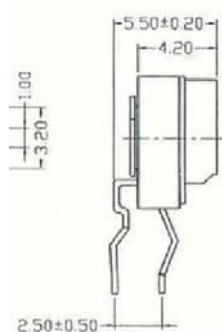
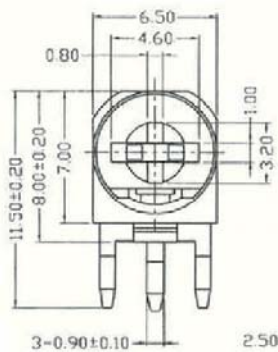

P.C.B. LAYOUT

### GP43A... Right Angle Type

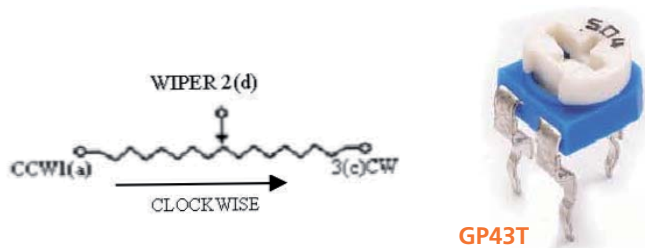

GP43T

Tolerance: ±0.25mm if no identification

RoHS Compliant

### General Specifications:

- > Nominal Resistance: 100Ω to 2MΩ
- > Standard Resistance Tolerance: ±10%, ±20%, ±30%
- > Residual Resistance: maximal 5% of nominal resistance, but under 30Ω
- > Power Rating: 0.1W for linear taper
- > Operating Voltage: 50V max.
- > Rotational Angle: 200°±20°
- > Rotational Torque: 30 to 350 g.cm
- > End-Stop Strength: 500 g.cm min.
- > Operating Temperature: -25°C to +40°C
- > Rotational Life: Max. ±5% change in resistance after 100 unloaded rotations
- > Load Life: Max. ±5% change in resistance after 3 hours loaded
- > Temperature Characteristics: +5% to -10% change in resistance after 5 hours at 70°C
- > Humidity Characteristics: Max. 20% change in resistance after 500 hours at 40°C and RH95% unloaded
- > Soldering Temperature: 260°C
- > Soldering Time: 3 seconds

### How to order:

GP43

- 1 TYPE:**
  - T Straight Type
  - A Right Angle Type
- 2 TYPE OF TAPER:**
  - B Linear (Standard)
- 3 RESISTANCE VALUE (Unit: Ω):**  
 free text 220 Ω to 5M Ω  
 e.g.: 220K for 220.000 Ω
- 4 RESISTANCE TOLERANCE:**
  - 10 ± 10%
  - 20 ± 20% (Standard)
  - 30 ± 30%

All specifications are restricted to QA test criteria.  
 DRW: D.L. JIN, CHK: D.F. LEE, APP: H.Z. QIU