

Multi-Direction Switches

Push & Lever Multifunction Switches

MB2 Series

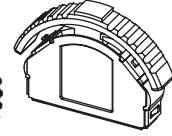

MB2NA
Standard Actuator,
without Ground Terminals

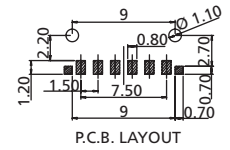
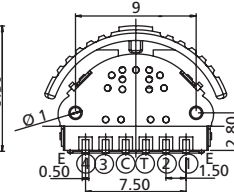
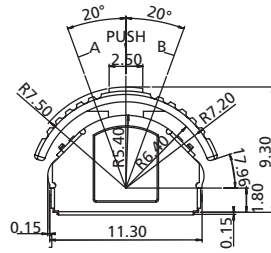

MB2NA with Standard Actuator

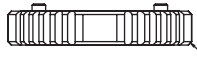

C or R 0.3

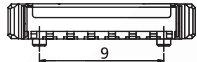
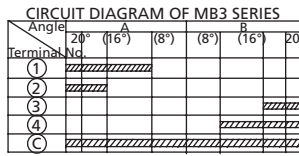

MB2NAG2
Standard Actuator,
with Ground Terminals

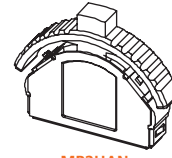
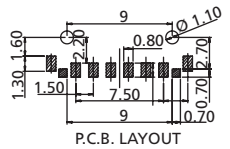
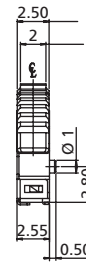
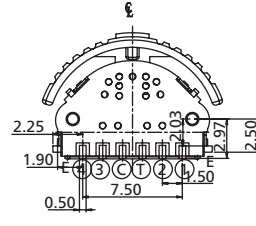
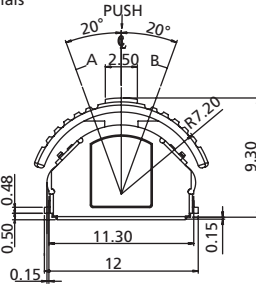

MB2HAN
High Actuator,
without Ground Terminals

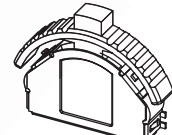
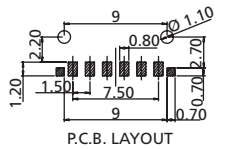
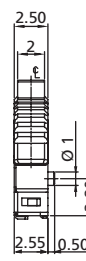
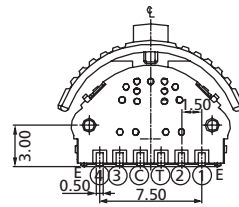
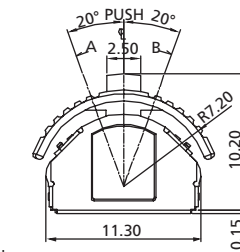

MB2HAG4
High Actuator,
with Ground Terminals

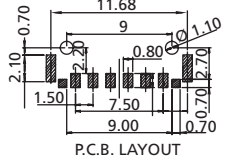
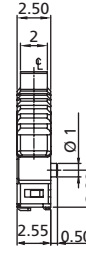
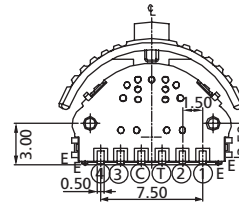
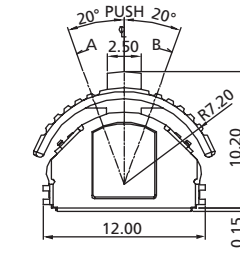

MB2HA with High Actuator

How to order:

MB2

- 1 ACTUATOR:**
 - NA Standard Actuator
 - HA High Actuator
- 2 GROUND TERMINAL:**
 - N Without Ground Terminal
 - G With Ground Terminal
- 3 NO. OF GROUND PINS (Only for MB2NAG & MB2HAG):**
 - 2 2 Ground Pins
 - 4 4 Ground Pins
- 4 COLOR OF SWITCH:**
 - A Black
 - H Gray
- 5 PACKAGE STYLE:**
 - TR Tape & Reel

General Tolerance: ± 0.2 mm

General Specifications:

FEATURES

- » J Type SMT push & lever switches
- » To provide both momentary operation by lever and center actuation

MATERIALS

- » Contact: Phosphor bronze with silver cladding at contact surface
- » Terminal: Phosphor bronze with silver cladding at contact surface

MECHANICAL

- » Mechanical Life: 100,000 operations cycles
- » Operating Force:
 - (A) Force on return actuator: 40±20 gf
 - (B) Force on center push direction: 150±50 gf
- » Operating Temperature: -10°C to +70°C
- » Storage Temperature: -25°C to +85°C

ELECTRICAL

- » Electrical Life: 100,000 cycles, 5VDC, 10mA
- » Non-Switching Rating: 100mA, 50VDC
- » Switching Rating: 10mA, 5VDC

SOLDERING PROCESSES

- » Reflow Soldering: When applying reflow soldering, the peak temperature or the reflow oven should be set to 260°C max 10 seconds max..